

THE  
ANCIENT AMERICAS  
*A Brief History and Guide to Research*

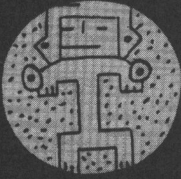

≡ HANNIS J. PREM ≡

Translated by  
Kornelia Kurbjuhn

## THE ANCIENT AMERICAS A Brief History and Guide to Research

Hannis J. Prem

Translated by Kornelia Kurbjuhn

Outlining the long and complex cultural history of Mesoamerica and South America, this volume places the last flowering of the Aztecs and Incas into their respective geographic and socio-cultural frameworks. A final section offers a topically arranged bibliography of over a thousand entries. An essential reference.

6 x 9, 205 pp

Paper \$24.95

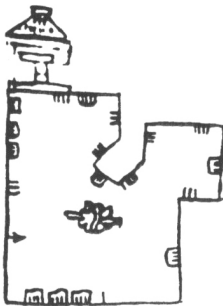

## The Códice de Santa María Asunción Households and Lands in Sixteenth-Century Tepetlaoztoc

Barbara J. Williams and H.R. Harvey

The Códice de Santa María Asunción, one of the most comprehensive native census pictorial manuscripts that has survived from central Mexico, provides a wealth of information on native rural life, social structure, settlement patterns, land tenure, household composition, political and economic organization, and cultural ecology and is one of a handful of remaining examples of indigenous record keeping.

34 color plates, 222 illustrations, 3 maps

9 x 12, 416 pp

Cloth \$275.00

*Available from bookstores or—*



THE UNIVERSITY OF UTAH PRESS

1795 E. South Campus Drive, Rm 101

Salt Lake City, UT 84112

(800) 773-6672; fax (801) 581-3365; [info@upress.utah.edu](mailto:info@upress.utah.edu)



**Statement of Ownership, Management, and Circulation**  
(Required by 39 USC 3685)

1. Publication Title <b>Latin American Antiquity</b>		2. Publication Number <b>1 0 4 5 - 6 6 3 5</b>			3. Filing Date <b>9/16/96</b>	
4. Issue Frequency <b>quarterly (Mar, June, Sept, Dec)</b>		5. Number of Issues Published Annually <b>4</b>			6. Annual Subscription Price <b>\$115.00</b>	
7. Complete Mailing Address of Known Office of Publication (Not printer) (Street, city, county, state, and ZIP+4) <b>Society for American Archaeology, 900 Second Street, N.E., #12 Washington, DC 20002-3557</b>					Contact Person <b>Janet Walker</b> Telephone <b>202/789-8200</b>	
8. Complete Mailing Address of Headquarters or General Business Office of Publisher (Not printer) <b>see above</b>						
9. Full Names and Complete Mailing Addresses of Publisher, Editor, and Managing Editor (Do not leave blank)						
Publisher (Name and complete mailing address) <b>Society for American Archaeology, 900 Second Street, N.E., #12 Washington, DC 20002-3557</b>						
Editor (Name and complete mailing address) <b>Gary Feinman, Department of Anthropology, University of Wisconsin, 1180 Observatory Drive, Madison, WI 53706</b>						
Managing Editor (Name and complete mailing address) <b>Janet Walker, Society for American Archaeology, 900 Second Street, N.E., #12 Washington, DC 20002-3557</b>						
10. Owner (Do not leave blank. If the publication is owned by a corporation, give the name and address of the corporation immediately followed by the names and addresses of all stockholders owning or holding 1 percent or more of the total amount of stock. If not owned by a corporation, give the names and addresses of the individual owners. If owned by a partnership or other unincorporated firm, give its name and address as well as those of each individual owner. If the publication is published by a nonprofit organization, give its name and address.)						
Full Name <b>Society for American Archaeology</b>		Complete Mailing Address <b>900 Second Street, N.E., #12 Washington, DC 20002-3557</b>				
11. Known Bondholders, Mortgagees, and Other Security Holders Owning or Holding 1 Percent or More of Total Amount of Bonds, Mortgages, or Other Securities. If none, check box <input type="checkbox"/> None						
Full Name		Complete Mailing Address				
12. Tax Status (For completion by nonprofit organizations authorized to mail at special rates) (Check one) <input type="checkbox"/> The purpose, function, and nonprofit status of this organization and the exempt status for federal income tax purposes: <input type="checkbox"/> Has Not Changed During Preceding 12 Months <input type="checkbox"/> Has Changed During Preceding 12 Months (Publisher must submit explanation of change with this statement)						

PS Form 3526, September 1995

(See Instructions on Reverse)

13. Publication Title <b>Latin American Antiquity</b>		14. Issue Date for Circulation Data Below <b>June 1996</b>	
15. Extent and Nature of Circulation		Average No. Copies Each Issue During Preceding 12 Months	Actual No. Copies of Single Issue Published Nearest to Filing Date
a. Total Number of Copies (Net press run)		1375	1350
b. Paid and/or Requested Circulation	(1) Sales Through Dealers and Carriers, Street Vendors, and Counter-Sales (Not mailed)	0	0
	(2) Paid or Requested Mail Subscriptions (include advertiser's proof copies and exchange copies)	1121	1146
c. Total Paid and/or Requested Circulation (Sum of 15b(1) and 15b(2))		1121	1146
d. Free Distribution by Mail (Samples, complimentary, and other free)		0	0
e. Free Distribution Outside the Mail (Carriers or other means)		12	12
f. Total Free Distribution (Sum of 15d and 15e)		1131	1158
g. Total Distribution (Sum of 15c and 15f)		1143	1170
h. Copies not Distributed	(1) Office Use, Leftovers, Spoiled	232	180
	(2) Returns from News Agents		
i. Total (Sum of 15g, 15h(1), and 15h(2))		1375	1350
Percent Paid and/or Requested Circulation (15c / 15g x 100)		98%	97.9%
16. Publication of Statement of Ownership <input checked="" type="checkbox"/> Publication required. Will be printed in the <b>March</b> issue of this publication. <input type="checkbox"/> Publication not required.			
17. Signature and Title of Editor, Publisher, Business Manager, or Owner <i>Janet Walker</i>		Date <b>9/16/96</b>	

I certify that all information furnished on this form is true and complete. I understand that anyone who furnishes false or misleading information on this form or who omits material or information requested on the form may be subject to criminal sanctions (including fines and imprisonment) and/or civil sanctions (including multiple damages and civil penalties).

**Instructions to Publishers**

- Complete and file one copy of this form with your postmaster annually on or before October 1. Keep a copy of the completed form for your records.
- In cases where the stockholder or security holder is a trustee, include in items 10 and 11 the name of the person or corporation for whom the trustee is acting. Also include the names and addresses of individuals who are stockholders who own or hold 1 percent or more of the total amount of bonds, mortgages, or other securities of the publishing corporation. In item 11, if none, check the box. Use blank sheets if more space is required.
- Be sure to furnish all circulation information called for in item 15. Free circulation must be shown in items 15d, e, and f.
- If the publication had second-class authorization as a general or requester publication, this Statement of Ownership, Management, and Circulation must be published; if must be printed in any issue in October or, if the publication is not published during October, the first issue printed after October.
- In item 16, indicate the date of the issue in which this Statement of Ownership will be published.
- Item 17 must be signed.

Failure to file or publish a statement of ownership may lead to suspension of second-class authorization.

PS Form 3526, September 1995 (Reverse)

# YOUR INVITATION TO MEMBERSHIP

## MEMBERSHIP CATEGORIES

Except as noted below, all members have voting privileges, may serve on committees, and receive *SAA Bulletin*, *Archaeologists of the Americas*, and one journal (either *American Antiquity* or *Latin American Antiquity*)—plus discounts on publications and meeting registration. Members may also choose to receive the newsletter *Archaeology and Public Education*, published three times each year.

**Regular Annual dues: \$110/\$40\***

Any person who is engaged in archaeology or any related aspect thereof or any person who supports the objectives of the society.

**Student Annual dues: \$50/\$37\***

Any person matriculating in an educational institution pursuing candidacy for a degree (Associate or higher) in a field of study related to some aspect of archaeology.

**Retired Annual dues: \$57/\$40\***

Any person who has retired from remunerative professional life.

**Joint Annual dues: \$23/\$12\***

Any person who is the spouse or domestic partner of a Regular, Life, Retired, or Student member and who supports the objectives of the society. Receives publications via member spouse or partner.

**Associate Annual dues: \$34/\$23\***

Any person who is not a professional archaeologist and who supports the objectives of the society. Non-voting member who does not receive a journal.

**Life Lifetime dues: \$2,850**

Any person who supports the objectives of the society may become a Life member under conditions as determined by the Executive Board.

\*Dues amounts listed above are standard and discount rates respectively: Standard Rate applies to members living in Australia, Bahrain, Bermuda, Brunei, Canada, Cyprus, Hong Kong, Israel, Japan, Korea, Kuwait, Libya, New Caledonia, New Zealand, Qatar, Saudi Arabia, Sultanate of Oman, Singapore, Taiwan, Thailand, United Arab Emirates, United States, or Western Europe. Discount Rate applies to members living in Latin America or any other country not included above.

\*\*Additional tax-deductible contributions support SAA's initiatives and are always welcome. Thank you.

Payment must accompany application. Student members must enclose a copy of current student identification to qualify for student rate.

Membership is based on the calendar year. Applications received before September 15 are fulfilled for the current year; applications received thereafter are treated as memberships for the next year.

## Society for American Archaeology (SAA)

is an international organization dedicated to the research, interpretation, and protection of the archaeological heritage of the Americas. With more than 5,500 members, the society represents student, avocational, and professional archaeologists working in a variety of settings including government agencies, colleges and universities, museums, and the private sector.

Since its inception in 1934, SAA has endeavored to stimulate interest and research in American archaeology; advocate and aid in the conservation of archaeological resources; encourage public access to and appreciation of archaeology; oppose all looting of sites and the purchase and sale of looted archaeological materials; and serve as a bond among those interested in the archaeology of the Americas.

Please make a photocopy for yourself and leave this form for the next person. Thank you!

**YES!** Please enroll me as a member of the Society for American Archaeology.

NAME \_\_\_\_\_

ADDRESS \_\_\_\_\_

ADDRESS \_\_\_\_\_

CITY STATE/PROVINCE COUNTRY ZIP/POSTAL CODE \_\_\_\_\_

PHONE FAX EMAIL \_\_\_\_\_

SIGNATURE *By my signature I subscribe to SAA's objectives*

Membership Dues \$ \_\_\_\_\_

Please check one of the following categories:

Regular  Retired  Associate  
 Student  Joint  Life

Journals \$ 0

As part of my membership dues, I wish to receive the following journal (select one):

*American Antiquity* OR  *Latin American Antiquity*

Optionally, I wish to add the following journal \$ \_\_\_\_\_ at the member subscription rate:

*American Antiquity* OR  *Latin American Antiquity*

\$50 for Regular members living in Standard Rate countries  
\$28 for Regular members living in Discount Rate countries  
and all Student and Retired members living in any country

Send me *Archaeology and Public Education*  
 Sign me up for the Rock Art Interest Group

Tax-deductible contribution\*\* \$ \_\_\_\_\_

TOTAL: \$ \_\_\_\_\_

Check or money order enclosed  
(payable in U.S. funds drawn on a U.S. bank)

VISA  MasterCard  American Express

Card No. \_\_\_\_\_ Exp. Date \_\_\_\_\_

Name \_\_\_\_\_ Signature \_\_\_\_\_

How did you hear about SAA? \_\_\_\_\_

Return to Society for American Archaeology  
c/o Riggs National Bank, Dept. 0123,  
Washington DC 20073-0123 USA

**SAA**  
SOCIETY FOR AMERICAN ARCHAEOLOGY

## NOTICE TO AUTHORS

*Latin American Antiquity* publishes original papers on the archaeology, prehistory, and ethnohistory of Latin America, i.e., those countries—primarily Spanish speaking—comprising Mesoamerica, Central America, and South America, together with culturally affiliated adjacent regions. Authors submit manuscripts to the editor for consideration as ARTICLES or REPORTS in English, Spanish, or Portuguese. Authors should submit an original and three copies of their manuscripts (including all figures, tables, references, and notes), along with an abstract in both English and Spanish. Detailed information on policy, style, and technical matters of manuscript preparation is given in the “Editorial Policy, Information for Authors, and Style Guide for American Antiquity and Latin American Antiquity,” which appeared in September 1992 (vol. 3, no. 3), and can be read on the World Wide Web at <http://www.saa.org/Publications/StyleGuide/styframe.html>. A Spanish style guide was published in *Latin American Antiquity* in July 1997 (vol. 8, no. 2). For additional information, updates, or clarification, consult the managing editor at the SAA office in Washington, D.C.

### EXECUTIVE BOARD OF THE SOCIETY FOR AMERICAN ARCHAEOLOGY

#### *Officers*

*President:* VINCAS STEPONAITIS, Research Labs of Anthropology, University of North Carolina, Chapel Hill, NC 27599-3120

*Secretary:* LYNNE SEBASTIAN, State Historic Preservation Division, 228 East Palace Avenue, Santa Fe, NM 87501

*Treasurer:* ROBERT L. BETTINGER, Department of Anthropology, University of California, Box 500, Davis CA 95617

*Treasurer-elect:* JEFFREY ALTSCHUL, P.O. Box 31865, Tucson, AZ 85751

#### *Board Members-at-Large*

C. MELVIN AIKENS, Department of Anthropology, University of Oregon, Eugene, OR 97403

MARGARET C. NELSON, Department of Anthropology, Arizona State University, Tempe, AZ 85287

DEBORAH M. PEARSALL, Department of Anthropology, University of Missouri, 107 Swallow Hall, Columbia, MO 65211

DONNA J. SEIFERT, John Milner Associates, 5250 Cherokee Avenue, Alexandria, VA 22312

GEORGE S. SMITH, Southeast Archeological Center, National Park Service, 2035 East Paul Dirac Drive, Suite 120, Box 7, Tallahassee, FL 32310

BONNIE W. STYLES, Illinois State Museum, 1011 East Ash Street, Springfield, IL 62703

#### *Ex-officio Executive Board Members*

*Executive Director:* TOBI A. BRIMSEK, Society for American Archaeology, 900 Second Street, N.E., Suite 12, Washington, DC 20002-3557

## ARTICLES

- 195 Nonmarket Imperialism in the Prehispanic Americas: The Inka Occupation of the Titicaca Basin  
*Charles Stanish*

## REPORTS

- 217 Early Formative Platforms at Paso de la Amada, Chiapas, Mexico  
*Richard G. Lesure*
- 237 Classic to Postclassic at Ek Balam, Yucatán: Architectural and Ceramic Evidence for Defining the Transition  
*George J. Bey III, Craig A. Hanson, and William M. Ringle*
- 255 Inka-Style Ceramics and Their Chronological Relationship to the Inka Expansion in the Southern Lake Titicaca Area (Bolivia)  
*Martti Pärssinen and Ari Siiriäinen*

## REVIEWS AND BOOK NOTES

### Reviews

- 273 Aztec Imperial Strategies, by Francis F. Berdan, Richard Blanton, Elizabeth Hill Boone, Mary G. Hodge, Michael E. Smith, and Emily Umberger  
*Susan Toby Evans*
- 274 The Managed Mosaic: Ancient Maya Agriculture and Resource Use, edited by Scott L. Fedick  
*Norman Hammond*
- 276 Images from the Underworld: Naj Tunich and the Tradition of Maya Cave Painting, by Andrea J. Stone  
*Mary Pohl*
- 277 Paths to Central American Prehistory, edited by Fredrick W. Lange  
*Michael J. Snarskis*
- 279 Pyramids of Tucume: The Quest for Peru's Forgotten City, by Thor Heyerdahl, Daniel Sandweiss, and Alfredo Narvaez  
*A. M. Ulana Klymyshyn*
- 280 Architecture and Power in the Ancient Andes: The Archaeology of Public Buildings, by Jerry D. Moore  
*Thomas Pozorski*
- 281 Limatambo: Archaeology, History and the Regional Societies of Inca Cusco, by Ken Heffernan  
*Gordon McEwan*
- 282 Astronomy and Empire in the Ancient Andes, by Brian S. Bauer and David S. P. Dearborn  
*R. Robert Robbins*
- 283 Tiwanaku and Its Hinterland: Archaeology and Paleoecology of an Andean Civilization. Volume 1: Agroecology, edited by Alan L. Kolata  
*Christine Hastorf*

### Book Notes

- 284 The Aztecs, by Michael E. Smith  
*Fredric Hicks*
- 284 Caciques and Their People: A Volume in Honor of Ronald Spores, edited by Joyce Marcus and Judith Francis Zeitlan  
*Joseph Whitecotton*
- 285 Secrets in Stone: Yokes, Hachas and Palmas from Southern Mesoamerica, by Edwin M. Shook and Elayne Marquis  
*Jan McHargue*
- 285 Art of the Andes: From Chavín to Inca, by Rebecca Stone-Miller  
*Alana Cordy-Collins*

On the cover: A Zapotec Classic-period clay funerary urn found in situ in a subfloor domestic tomb at the Ejutla site, Oaxaca, Mexico. Drawings by Paul Schulze and Jennifer Vesper.

En la portada: Urna funeraria zapoteca clásica hallada in situ en una tumba doméstica bajo el piso en el sitio de Ejutla, Oaxaca, Mexico. Dibujos hechos por Paula Schulze y Jennifer Vesper.